

| Item | Article No. | Designation | Qt.à |
|------|-------------|----------------------|------|
| 1 | 7TA2400 | FRAME | 1 |
| 2 | 7CA2400N | COVER | 1 |
| 3 | 9602 | GASKET G/295 | 1 |
| 4 | 71001 | ARM | 1 |
| 5 | 93002 | PIN §10X56 | 1 |
| 6 | 95021 | SCREW TE M10X60 | 1 |
| 7 | 95420 | CIRCLIP RING §8 | 1 |
| 8 | 95206 | SELF LOCKING NUT M10 | 2 |
| 9 | 95012 | SCREW TE M10X30 | 1 |
| 10 | 91001 | SPINDLE M10 L=105 | 1 |
| 11 | 94161 | HANDLE MEC/60A M10 | 1 |
| 12 | 97321 | BLU CAP | 1 |

NEW GASKET (starting from April 2009)

| Article No. | Material | COLOR | Temperature |
|-------------|----------|----------------|-------------|
| 96020 | NBR | WHITE RAL 9016 | -30°/ 110°C |
| 96021 | EPDM | GREY RAL7040 | -15°/ 90°C |
| 96025 | SILICON | CLEAR WHITE | -50°/200°C |
| 96026 | FKM | BLACK RAL 9017 | -10°/ 250°C |

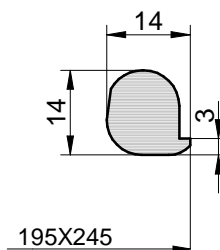

OLD GASKET (until March 2009)

| Article No. | Material | COLOR | Temperature |
|-------------|----------|----------------|-------------|
| 96020-04B | NBR | WHITE RAL 9016 | -30°/ 110°C |
| 96021-04E | EPDM | GREY RAL7040 | -15°/ 90°C |
| 96025-04S | SILICON | CLEAR WHITE | -50°/200°C |
| 96026-04V | FKM | BLACK RAL 9017 | -10°/ 250°C |

