



ARCHON Industries, Inc.

LIGHTING UNIT FOR SCREW-ON SIGHT GLASS Model # **HLM / HLMR 65**



Installation / Operation / Maintenance Instruction

Instruction #:
Issued:

1009.2
7/11/08

357 Spook Rock Road
Bldg # 1 – 505
Suffern, NY 10901



Tel.: (845) 368-3600
Fax: (845) 368-3040
sales@archonind.com

Use A LICENSED ELECTRICIAN AND CHECK WITH LOCAL AND NATIONAL CODES

These units are intended for Dry or Damp locations only.

GENERAL REMARKS

1. Storage should be in a dry and sheltered place.
2. Installation and Maintenance has to be performed only by qualified personnel.
3. For use in especially aggressive surroundings, an additional corrosion protection should be considered.
4. Prior to installation or maintenance, the indications or remarks on the nameplate should be thoroughly read, understood and followed.
5. In case of frequent and repetitive use of built-in push buttons, observe the increase of housing temperature.
6. The increase of the housing temperature depending of the sight glass flange temperature and the ambient temperature has to be observed for lighting unit working in mode with "On/Off switch" or "continuous operation". Depending of the results and the local law, codes and regulations, appropriate preventive measures have to be taken.

INSTALLATION

1. Prior to installation it should be verified that the protection rating of the light is suitable for the intended location and events in that location (e.g. cleaning).
2. All relevant indications and remarks on the nameplates should be read and understood prior to installation.
3. Always ensure that the light is connected to the correct supply voltage as indicated on the nameplate.
4. All lighting units are uniquely designed to fit on sight glass assemblies. Never use a light in place of the cover flange or glass disc on a sight glass or in place of the sight glass assembly itself.

357 Spook Rock Road
Bldg # 1 – 505
Suffern, NY 10901



Tel.: (845) 368-3600
Fax: (845) 368-3040
sales@archonind.com

5. Lighting units with built-in push buttons or timers should be operated only with these devices.
6. In addition top all service parameters influencing the temperature of the glass disc built into a sight glass, temperature increase of the glass disc caused by operation of a mounted light should also be considered.
7. Possible heat transfer from installed sight glass to the lighting unit has to be taken into consideration.
8. Service life of bulbs / reflector-bulbs may be detrimentally influenced by vibration.

MAINTENANCE

1. For replacement bulb / reflector-bulbs always use an identical type and wattage (see nameplate and data sheet).
2. Never touch replacement bulbs with your fingers. Always use a proper cloth.
3. Only original spare parts for repair and maintenance work should be used.

NOTE* All finished wiring is located within the light housing.



This unit is not intended to remain ON for extended periods. An ON-OFF switching device must be installed in the power supply circuit. If the light is allowed to remain ON for an extended time, the lighting unit may become very hot and result in damage to the internal electrical components.

If you have any questions, please contact ARCHON Industries directly @

Tel.: **(800) 554-1394**

Fax: **(845) 368-3040**

E-mail: sales@archonind.com

Thank you for using ARCHON products.

357 Spook Rock Road
Bldg # 1 – 505
Suffern, NY 10901



Tel.: (845) 368-3600
Fax: (845) 368-3040
sales@archonind.com

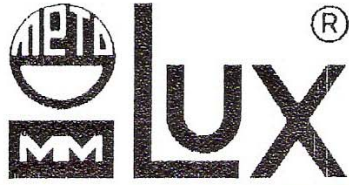

CONSTRUCTION AND COMPONENTS
SIGHT GLASS LIGHT FITTINGS metaLUX[®]

TYPE HLMR 65 H (24V/20W)
 TYPE HLMR 65 H sp (12V/20W)

- 0054 Cable terminal
- 0088 Cover to push button
- 0112 Spring washer
- 0113 Slotted cheese head screw
- 0152 Slot nail
- 0192 Slotted cheese head screw
- 0402 Slotted cheese head screw
- 0403 Distance ring
- 1114 Terminal block
- 1138 Sealing ring
- 1160 Push button
- 1238 Sealing ring
- 1542 Halogene bulb 12V/20W
- 2740 Lamp socket GY 6.35
- 3042 Halogene bulb 24V/20W
- 3148 Cover
- 3651 Name plate
- 6149 Cover gasket
- 7101 Housing
- 7149 Housing gasket
- 7715 Cable gland

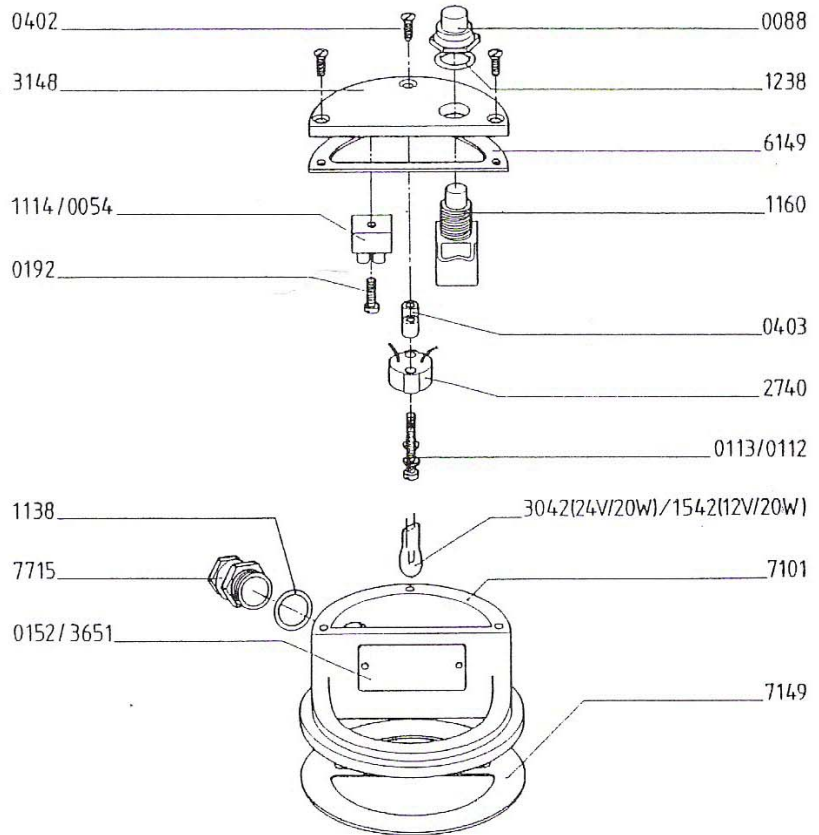

357 Spook Rock Road
 Bldg # I – 505
 Suffern, NY 10901



Tel.: (845) 368-3600
 Fax: (845) 368-3040
sales@archonind.com