



ARCHON Industries, Inc.

SIGHT GLASS LIGHTING UNIT

Model # HL 24V / 100W



Installation / Operation / Maintenance Instruction

Instruction #: **1027**
Issued: **11/15/2004**

357 Spook Rock Road
Bldg # 1 – 505
Suffern, NY 10901



Tel.: (845) 368-3600
Fax: (845) 368-3040
sales@archonind.com

Use A **LICENSED ELECTRICIAN AND CHECK WITH LOCAL AND NATIONAL CODES**

These units are intended for Dry or Damp locations only.

GENERAL REMARKS

1. Storage should be in a dry and sheltered place.
2. Installation and Maintenance has to be performed only by qualified personnel.
3. For use in especially aggressive surroundings, an additional corrosion protection should be considered.
4. Prior to installation or maintenance, the indications or remarks on the nameplate should be thoroughly read, understood and followed.
5. In case of frequent and repetitive use of built-in push buttons, observe the increase of housing temperature.
6. The increase of the housing temperature depending of the sight glass flange temperature and the ambient temperature has to be observed for lighting unit working in mode with "On/Off switch" or "continuous operation". Depending of the results and the local law, codes and regulations, appropriate preventive measures have to be taken.

INSTALLATION

1. Prior to installation it should be verified that the protection rating of the light is suitable for the intended location and events in that location (e.g. cleaning).
2. All relevant indications and remarks on the nameplates should be read and understood prior to installation.
3. Always ensure that the light is connected to the correct supply voltage as indicated on the nameplate.
4. All lighting units are uniquely designed to fit on sight glass assemblies. Never use a light in place of the cover flange or glass disc on a sight glass or in place of the sight glass assembly itself.

357 Spook Rock Road
Bldg # 1 – 505
Suffern, NY 10901



Tel.: (845) 368-3600
Fax: (845) 368-3040
sales@archonind.com

5. Lighting units with built-in push buttons or timers should be operated only with these devices.
6. In addition to all service parameters influencing the temperature of the glass disc built into a sight glass, temperature increase of the glass disc caused by operation of a mounted light should also be considered.
7. Possible heat transfer from installed sight glass to the lighting unit has to be taken into consideration.
8. Service life of bulbs / reflector-bulbs may be detrimentally influenced by vibration.

MAINTENANCE

1. For replacement bulb / reflector-bulbs always use an identical type and wattage (see nameplate and data sheet).
2. Never touch replacement bulbs with your fingers. Always use a proper cloth.
3. Only original spare parts for repair and maintenance work should be used.

NOTE* All finished wiring is located within the light housing.



This unit is not intended to remain ON for extended periods. An ON-OFF switching device must be installed in the power supply circuit. If the light is allowed to remain ON for an extended time, the lighting unit may become very hot and result in damage to the internal electrical components.

If you have any questions, please contact ARCHON Industries directly @

Tel.: **(800) 554-1394**

Fax: **(845) 368-3040**

E-mail: sales@archonind.com

Thank you for using ARCHON products.

357 Spook Rock Road
Bldg # 1 – 505
Suffern, NY 10901



Tel.: (845) 368-3600
Fax: (845) 368-3040
sales@archonind.com



CONSTRUCTION AND COMPONENTS SIGHT GLASS LIGHT FITTINGS metaLUX®

TYPE HL 100/125 H (24V/50W)
 TYPE HL 100/125 H sp (12V/50W)
 TYPE HL 150/200 H (24V/100W)
 TYPE HL 150/200 H sp (12V/100W)

- 0009 Spring washer
- 0031 Socket cap bolt
- 0039 Socket cap bolt
- 0040 Spring washer
- 0041 Spring washer
- 0042 Socket cap bolt
- 0052 Slot nail
- 0054 Cable terminal
- 0088 Cover to push button
- 0090 Socket cap bolt
- 0092 Slotted cheese head screw
- 0138 Slotted cheese head screw
- 0311 Distance ring
- 0325 Distance piece
- 0344 Socket cap bolt
- 1114 Terminal block
- 1160 Push button
- 1238 Sealing ring
- 1336 Reflector
- 1340 Lamp socket GY 6.35
- 1842 Halogene bulb 12V/100W
- 3548 Cover HL 100
- 3648 Cover HL 125
- 3748 Cover HL 150
- 3848 Cover HL 200
- 4349 Cover gasket HL 100
- 4449 Cover gasket HL 125
- 4549 Cover gasket HL 150
- 4642 Halogene bulb 24V/100W
- 4649 Cover gasket HL 200
- 4742 Halogene bulb 24V/50W
- 5601 Housing HL100
- 5701 Housing HL125
- 5801 Housing HL150
- 5901 Housing HL200
- 6451 Name plate HL 100
- 6551 Name plate HL 125
- 6651 Name plate HL 150
- 6749 Cover gasket HL 100
- 6751 Name plate HL 200
- 6849 Cover gasket HL 125
- 6949 Cover gasket HL 150
- 7049 Cover gasket HL 200
- 7738 Sealing ring
- 7815 Cable gland
- 8542 Halogene bulb 12V/50W

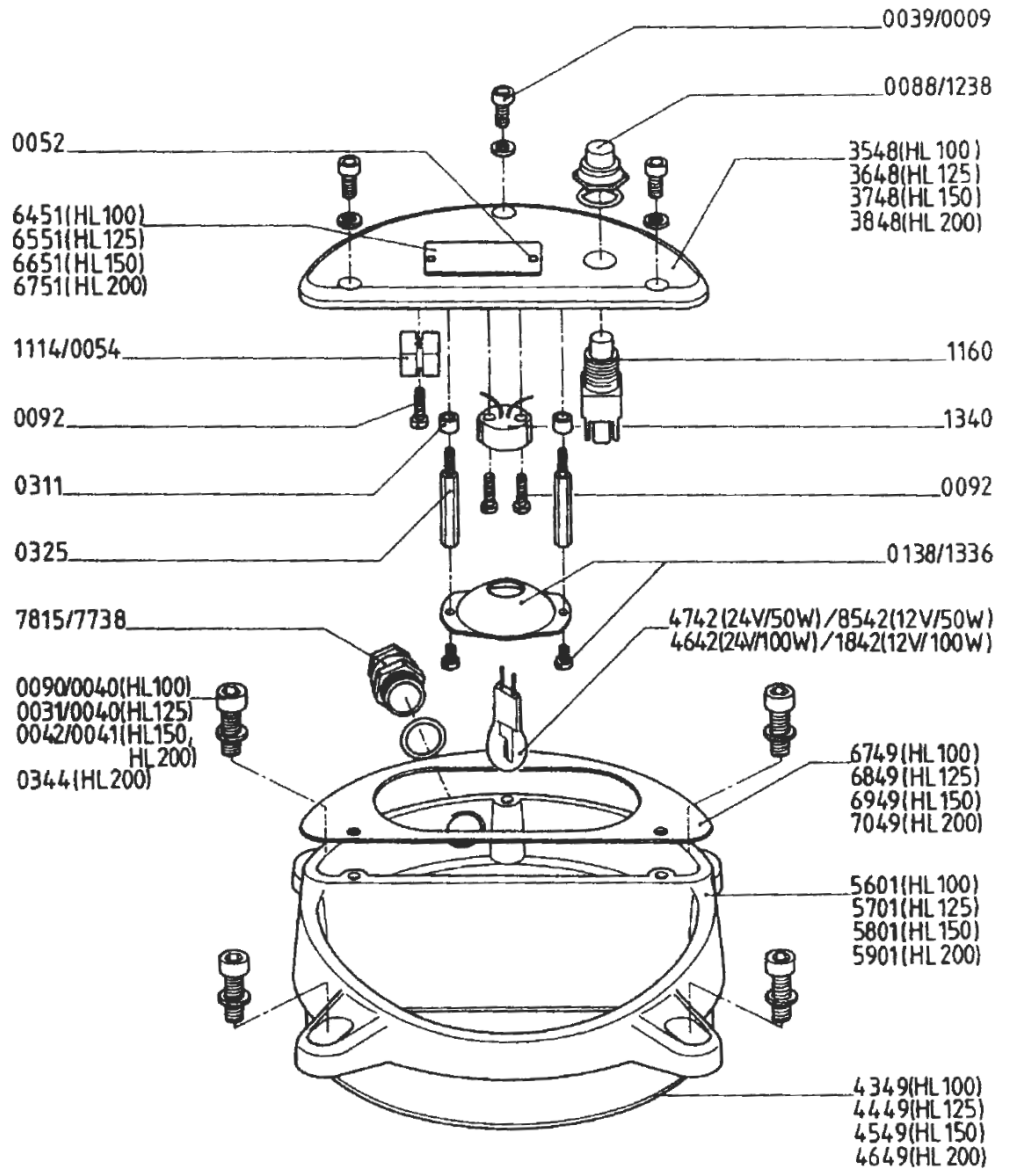

357 Spook Rock Road
 Bldg # I – 505
 Suffern, NY 10901



Tel.: (845) 368-3600
 Fax: (845) 368-3040
 sales@archonind.com